

163 Series Micro Switch

Features 特點

- | | |
|-------------------------------------|-------------|
| 1. Long Life Coil Spring Mechanism. | 採用耐用的螺形彈簧機構 |
| 2. Large Overtravel. | 大行程 |
| 3. Integral Hinged Actuator. | 內裝鉸接式活動部件 |
| 4. Rock Wipe Contact Action. | 搖動封閉式接觸動作 |
| 5. Customer Designs. | 按客戶需要設計 |

Applications 用途

Joystick, TV game, time recorder, air conditioner, food processor, juice maker, alarm, mixer, shredder machine, etc

適用於遊戲操作杆，電視遊戲機，定時器，空調，食品處理機，榨汁機，報警器，攪拌機，碎紙機等。

Specifications 規格說明

Rating 額定負荷	TXJ3 3A 125V/250VAC	Mechanical Life 機械壽命	5,000,000 cycles
	TXJ5 5A 125V/250VAC		
	TXJ6 6A 125V/250VAC	Electrical Life 電氣壽命	10,000 cycles
	TXJ10 10A 125V/250VAC		
Contact Resistance 接觸電阻	500mΩ Max.	Ambient Temper. Used 適用溫度	-25°C to 85°C
Insulation Resistance 絕緣電阻	>100MΩ DC500V	Ambient Humidity Used 適用濕度	<85% RH
Withstand Voltage 耐電壓	AC1000V 1min.	Operating Force 操作力	See Table
Soldering Temper. 焊接溫度	260 ± 5°C 3S		

SCHEMATIC

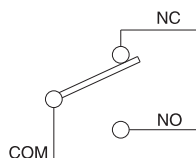

Mounting Hole Detail

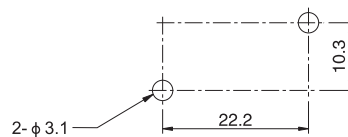

Mounting holes
or M3 screw holes

Ratings 額定負載

3A	125/250VAC CQC, UL, VDE	5A	125/250VAC CQC, UL, VDE
6A	125/250VAC CQC, UL, VDE	10A	125/250VAC CQC, VDE

Coding Rule 編號規則

163 □□ □ □ □ □□ □ □□ □□ □
I II III IV V VI VII VIII IX X

I :Code of product series: three-digit
163: TXJ series of spring structure.

I :產品系列代號 3位
163表示 TXJ彈簧結構

II :Load specification, in accordance with IEC61058, double-digit

II :負載類型:按IEC61058區分 2位

代号 Code	負載規格 Load specification	代号 Code	負載規格 Load specification
00	0.1A 125/250VAC	13	13(3)A 125/250VAC
01	1A 125/250VAC	14	14(3)A 125/250VAC
03	3A 125/250VAC	15	15(4)A 125/250VAC
05	5A 125/250VAC	16	16(4)A 125/250VAC
06	6A 125/250VAC	22	22(8)A 125/250VAC
10	10A 125/250VAC	25	25(8)A 125/250VAC
11	11(3)A 125/250VAC	30	30(10)A 125/250VAC
12	12(3)A 125/250VAC		

III :Used temperature range: single-digit
0:T55 1:25T85 2:25T130

III :使用溫度範圍 1位
0:T55 1:25T85 2:25T130

IV :Loop: single-digit
1:SPDT 2:SPST-NC 3:SPST-NO

IV :開關回路數 1位
1:SPDT 2:SPST-NC 3:SPST-NO

V :Type of terminal: single-digit
1:soldering terminal
2:PCB terminal, left toward
3:PCB terminal, right toward
4:187 type inserting terminal
5:187 type inserting and solder terminal
6:250 type inserting terminal
7:screwed terminal
8:187 type inserting vertical terminal

V :端子類型 1位
1:焊綫端子
2:左PCB端子
3:右PCB端子
4:187快接端子
5:187快接焊綫端子
6:250快接端子
7:螺紋端子
8:187快接垂直端子

VI :Handle type: double-digit
00: without handle 01:#01 handle
02: #02 handle

VI :手柄類型 2位
00:無手柄 01:01#手柄
02:02#手柄

VII :Position of handle: single-digit
0:without handle 1:standard
2:high OP

VII :手柄位置 1位
0:無手柄 1:標準位置
2:高轉換位置

VIII :Operating force (no level): double-digit

VIII :操作力(按無柄時操作力區分) 2位

代号 Code	操作力 規格 Operation force	代号 Code	操作力 規格 Operation force
01	10	11	100
02	15	12	130
03	18	13	150
04	20	14	160
05	25	15	180
06	30	16	200
07	40	17	250
08	50	18	300
09	70	19	320
10	80	20	340

IX :Derivative code: double-digit
Including the below, but not limited.
1:Same terminal type and unconventional structure
2:Difference of operation position
3:Color of button and housing
4:Difference of electroplating type
5:Difference of contact

IX :衍生序列號 2位
包括但不限于以下內容納入衍生序列號:
1:同類的端子形狀、折彎方向或其他非常規結構;
2:OP段要求不同;
3:按鈕顏色/膠殼顏色;
4:電鍍類型不同;
5:觸點不同.

X :Type of package: single-digit
0 = plastic bag 1=shrinked plastic package
2 =belting package 3 =tube package
4=foam package 5=undetermined

X :包裝方式 1位
0 =膠袋包裝 1 =吸塑盒裝
2 =編帶包裝 3 =管裝
4 =保利龍 5=待定

1630311400011001

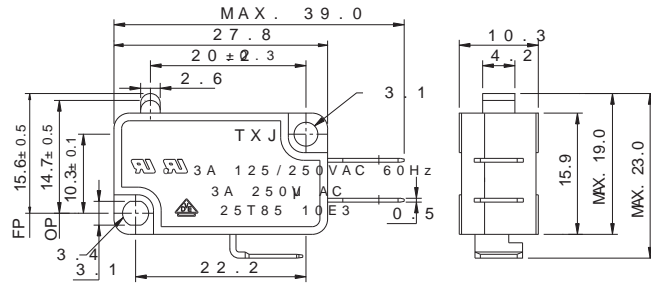
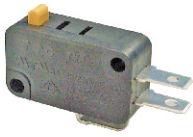

1630511401116000

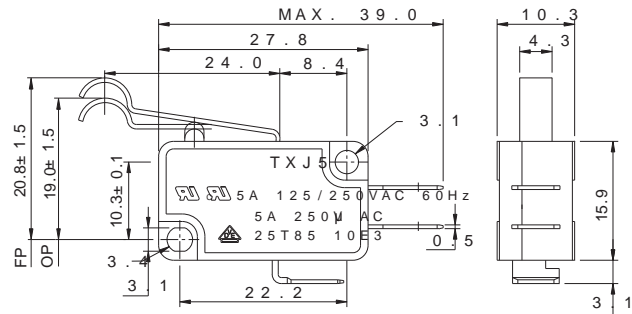
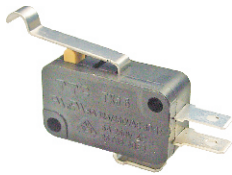

1630611402119000

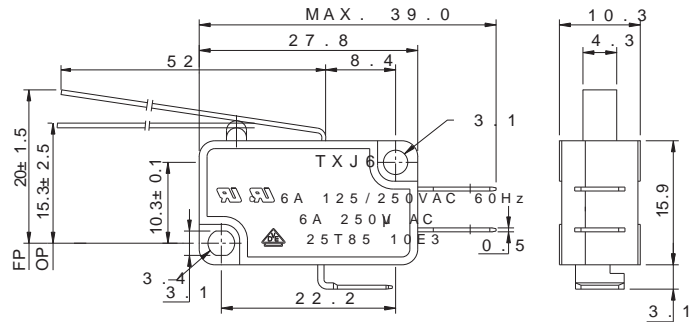
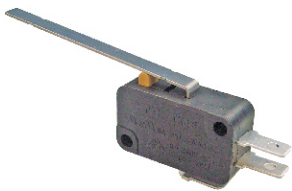

1631011403113001

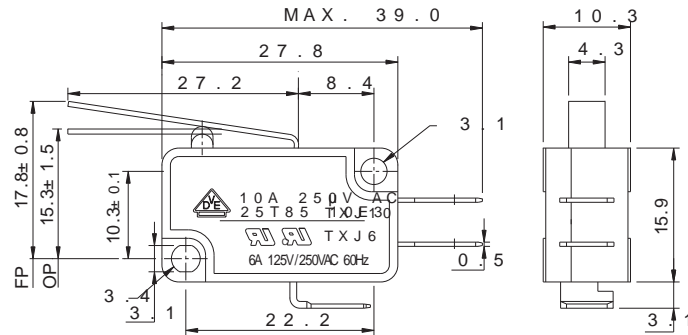
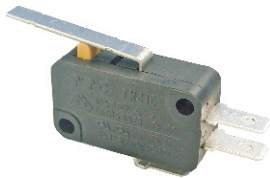

1630511404113001

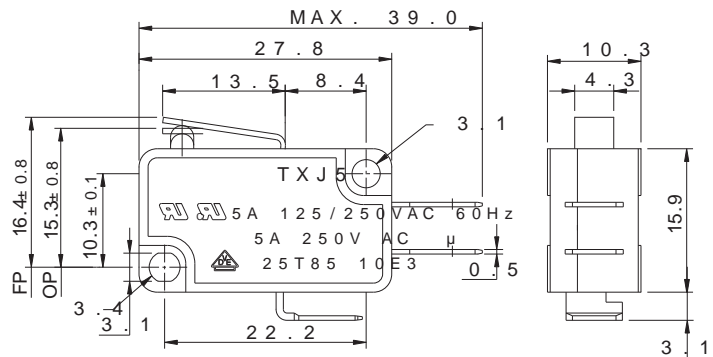

1630511405116001

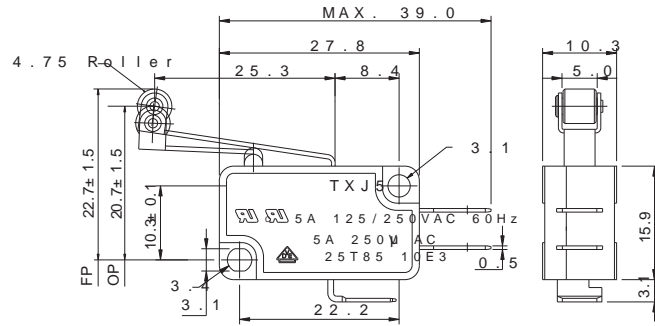
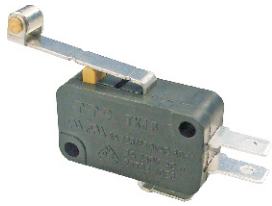

1630511406111001

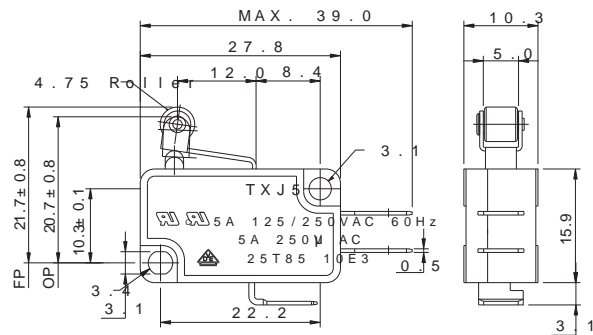
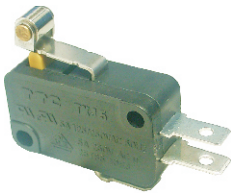

1630613808117000

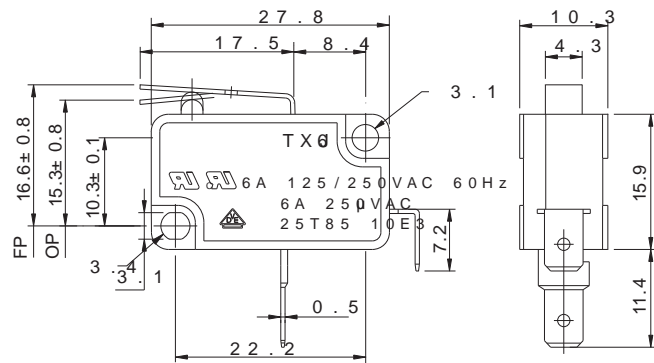

1631013409113001

